

William Gilchrist Andrew Donaldson

Robert Atwell

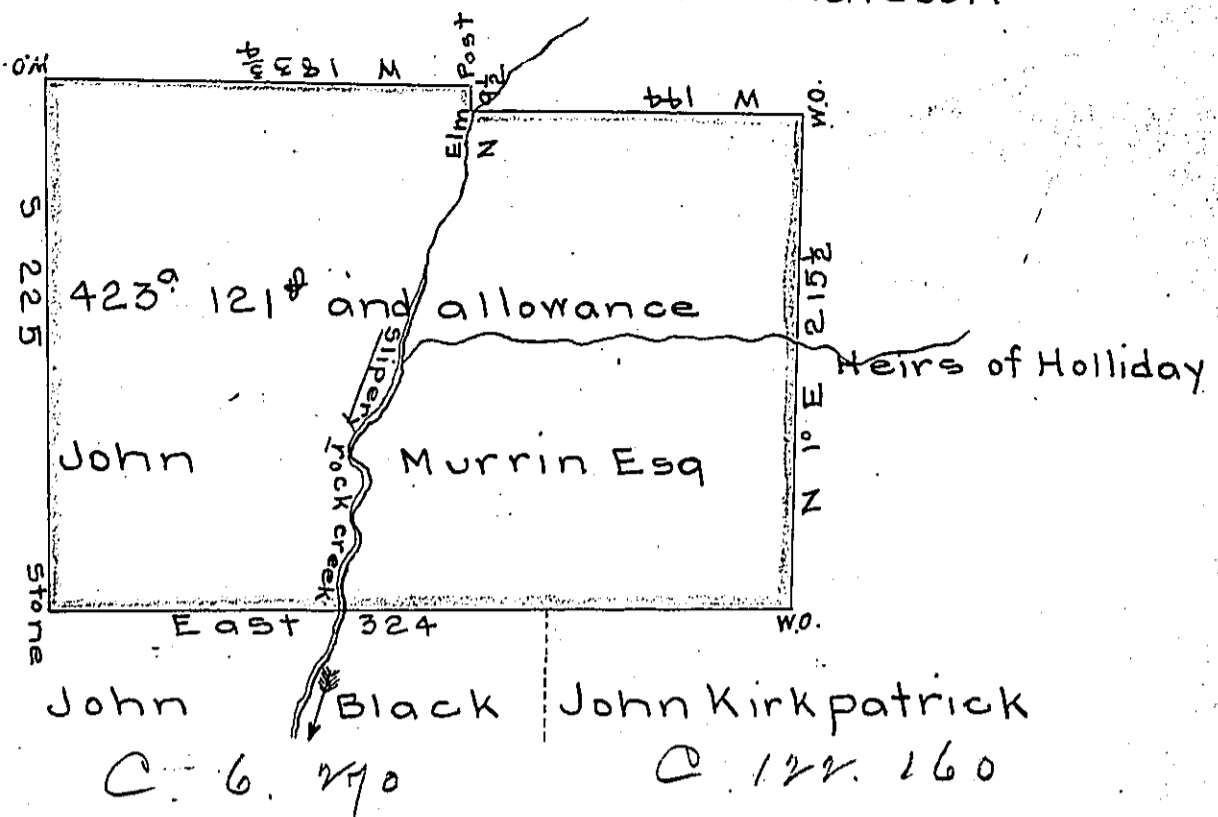

Draft of a tract of land situated on the waters of Slippery rock creek Mercer tp. Butler County containing 423° 121 perches and allowance surveyed the 6<sup>th</sup> day of December 1823 at the instance of John Murrin Esq. for the legal heirs and representatives of William Stewart deceased on settlement and improvement.

W<sup>m</sup> Purviance D.S.

I Hugh M<sup>c</sup> Kee Deputy surveyor of the county of Butler do certify the above to be the true and exact copy as they are to be found on the survey book of W<sup>m</sup> Purviance in my office.

Hugh M<sup>c</sup> Kee D.S.

To the Hon. John Laporte, Surveyor General

I Hugh M<sup>c</sup> Kee Deputy surveyor of the County of Butler do certify that after a careful examination of Books and papers in my possession that the above described tract of land is yet unpatented or otherwise appropriated by you. Witness my hand and seal this 27<sup>th</sup> day of Jan. A.D. 1851.

Hugh M<sup>c</sup> Kee



*IN TESTIMONY that the above is a copy of the original remaining on file in the Department of Internal Affairs of Pennsylvania, made conformably to an Act of Assembly approved the 16th day of February, 1833, I have hereunto set my Hand and caused the Seal of said Department to be affixed at Harrisburg, this thirtieth day of January 1906*

*Geo. B. Brown*  
Secretary of Internal Affairs.